

Drawing Number  
W1082J-HCT-DRG-EAR-002211

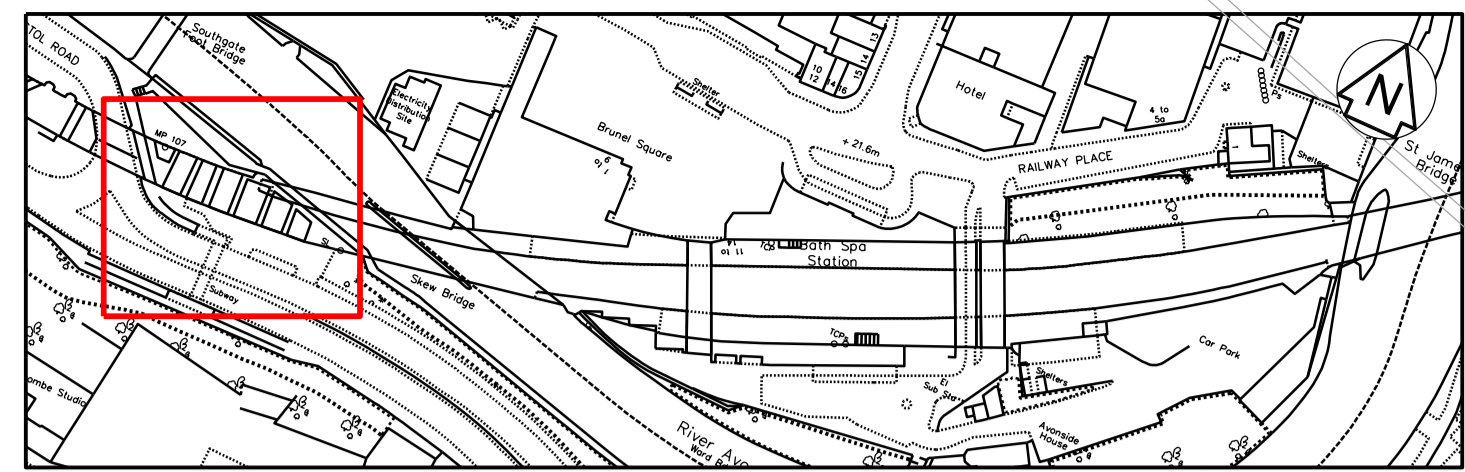

**COLOUR LEGEND:**

	EXISTING TO BE RETAINED
	EXISTING TO BE MODIFIED
	PROPOSED



**KEY PLAN**  
SCALE 1:2000

- Legend/Notes**
- 1- ALL DIMENSIONS ARE IN MILLIMETRES UNLESS NOTED OTHERWISE.
  - 2- ALL LEVELS ARE INDICATIVELY IN METRES ABOVE ORDNANCE DATUM.
- NOTES:**
- ① - NEW PLATFORM EDGE WARNING BLISTER TACTILES.
  - ② - NEW PLATFORM COPERS
  - ③ - EXISTING PLATFORM RESURFACED WITH MACADAM.
  - ④ - HATCHED AREA DENOTES EXTENT OF ORIGINAL VICTORIA PATENT STONE SLABS CAREFULLY LIFTED AND RE-BED TO REVISED FALLS.
  - ⑤ - LIGHTING COLUMNS TO MATCH EXISTING WITH LED FITTINGS.
  - ⑥ - NEW PA SYSTEM.
  - ⑦ - NEW DRAINAGE CHANNEL WITH DUCTILE IRON GRATING.
  - ⑧ - NEW CORDUROY TACTILES.
  - ⑨ - NEW YELLOW WARNING LINE BEHIND BLISTER TACTILES.
  - ⑩ - FOR DETAILS OF OLE EQUIPMENT AND ASSOCIATED WORKS REFER TO SEPARATE APPLICATION.
  - ⑪ - NEW 1100mm HIGH LAMINATED GLASS BALUSTRADE .
  - ⑫ - NEW RECESSED MANHOLE COVER.
  - ⑬ - NEW DUCTILE IRON MANHOLE COVER.
  - ⑭ - NEW PLATFORM END BARRIER.
  - ⑮ - TIMBER BALUSTRADE TO BE EXTENDED TO MATCH ORIGINAL DESIGN.
  - ⑯ - NEW KERB TO BE INSTALLED TO BACK OF PLATFORM INFRONT OF EXISTING RAILINGS.
  - ⑰ - NEW PLATFORM SIGNAGE.
  - ⑱ - NEW END OF PLATFORM STAIR.
  - ⑲ - EXISTING BENCH TO BE RELOCATED
  - ⑳ - MASONRY WALL TO BE RAISED - REFER TO DRAWING No W1082J-HCT-DRG-EAR-002307
  - ㉑ - NEW RAILINGS TO BE FITTED IN PLACE OF EXISTING. REFER TO DRAWING W1082J-HCT-DRG-EAR-002308

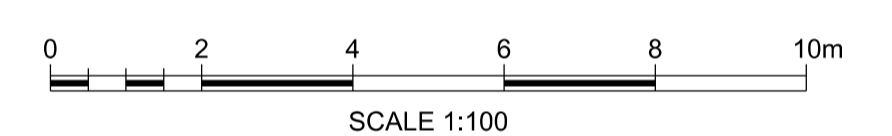
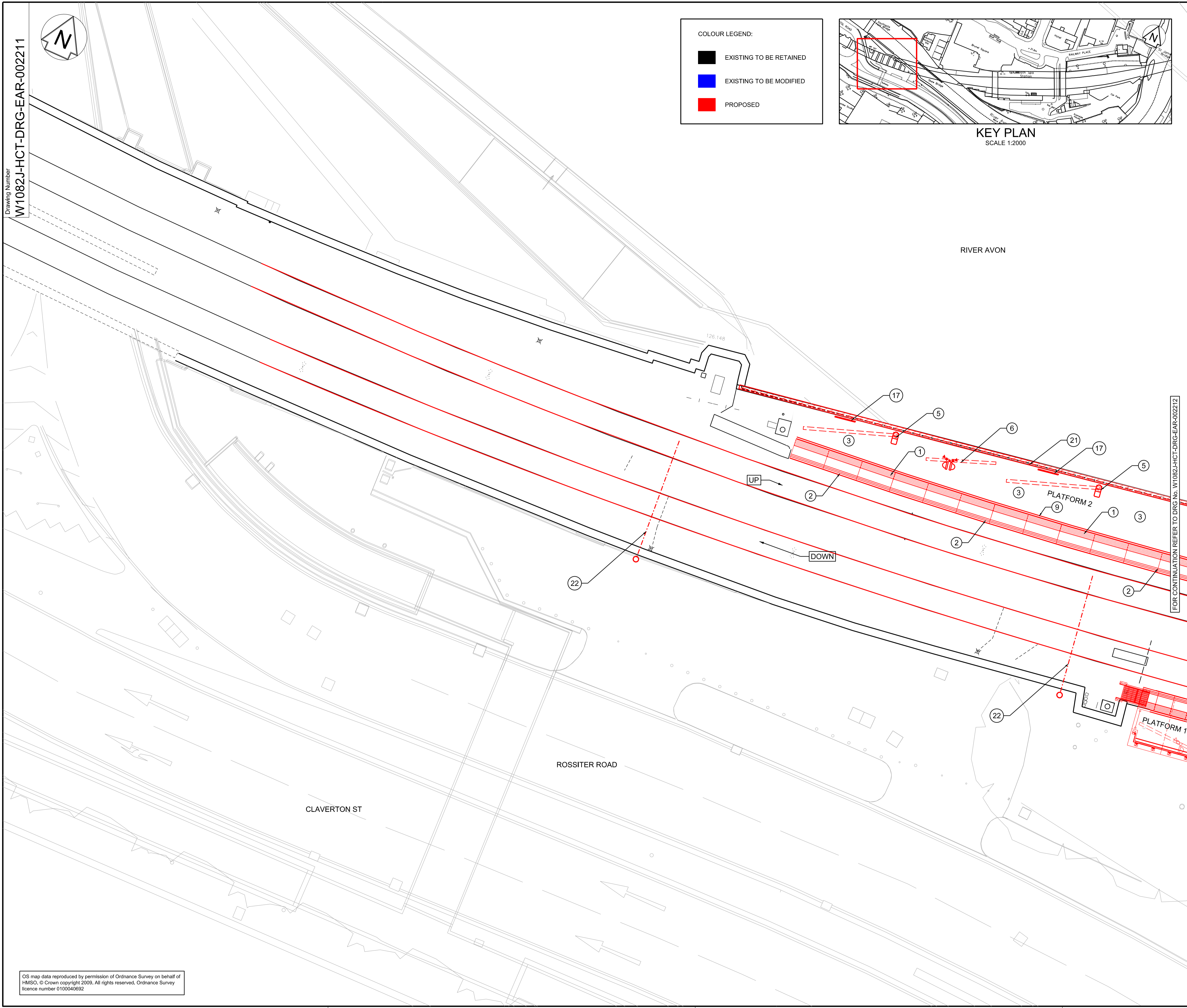

Rev	Date	Description of Revisions	Drawn	Chkd	Appr	Suitability
A01	28/9/16	ISSUED FOR REVIEW				HS

**FIT FOR IDR REVIEW**

S3



Contractor(s)

**Project**

GREAT WESTERN  
ROUTE MODERNISATION  
BATH CORRIDOR STATIONS

**Drawing Title**

BATH SPA STATION  
PROPOSED PLAN  
SHEET 1

Designed	H LINDSAY	Signed		Date	28/9/16
Drawn	C DUVALMA	Signed		Date	28/9/16
Checked	A POSTINGS	Signed		Date	28/9/16
Approved	H SIMPSON	Signed		Date	28/9/16
Scale(s)	1:100	ELR & Mileage	MLN1 106m 71ch		
Alternative Reference	C115026	Sheet	1 of 6		
Drawing Number	W1082J-HCT-DRG-EAR-002211	Revision	A01		

OS map data reproduced by permission of Ordnance Survey on behalf of HMSO. © Crown copyright 2009. All rights reserved. Ordnance Survey licence number 0100040692