



**Oaktree Environmental Ltd**  
 Waste Management and  
 Environmental Consultants  
 Unit 5, Oaks Park, Road One  
 Winsford Industrial Estate  
 Winsford, Cheshire CW7 3RY  
 Tel: 01606 558833 Fax: 01606 861182  
 E-mail: sales@oaktree-environmental.co.uk

Title: **INDICATIVE PHASING PLAN**

Drawing No: **2055/126/08**

Client: **Larry Edmunds**

Site: **Stowey Quarry, Stowey Road, Cameley**

NGR:

Date: **2 December 2010** Printed At: **A4**

Scale: **1:2,500** Revision: **-** Drawn By: **RS**

Job No: **2055** Client No: **126** Checked:

**Notes:**

Plan shown for indication only. Cell sizes and timing of fill may vary according to operational requirements at that time.

Phasing progressing from 1 to 11 as shown. Area to Southeast (i.e. offices, weighbridge and access road) to be graded to finished levels (Drawing No. 2055/126/05) following completion of phasing.

Reproduced with the permission of the controller of H.M.S.O. Crown copyright licence No. 100015148

**Revision Details:**

Rev:	Description:	Date:
-	Initial drawing	02/12/10

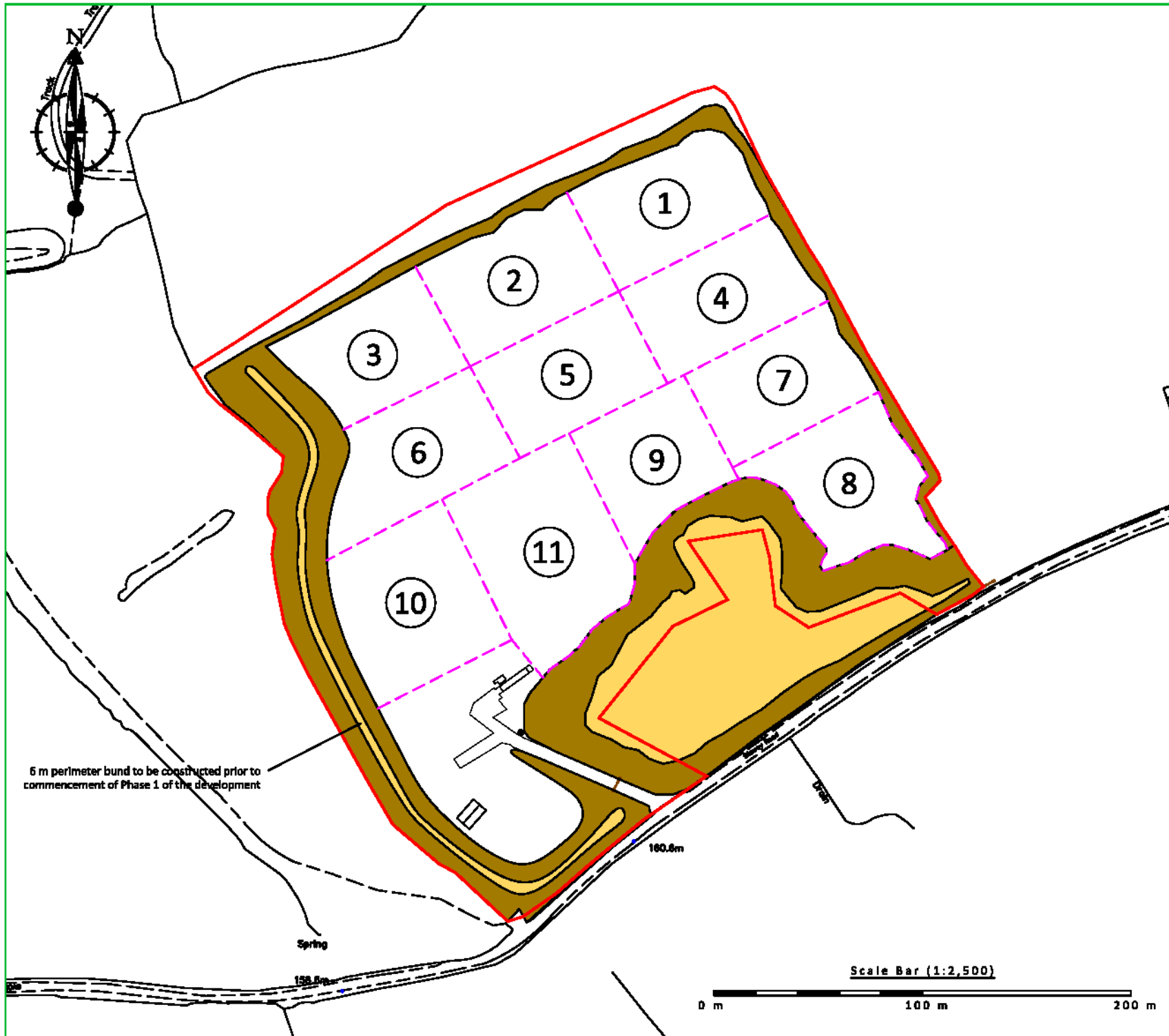

6 m perimeter bund to be constructed prior to commencement of Phase 1 of the development

Scale Bar (1:2,500)